

MODEL 201-MB

Application for
Modified Membrane Application

CROSS SECTION

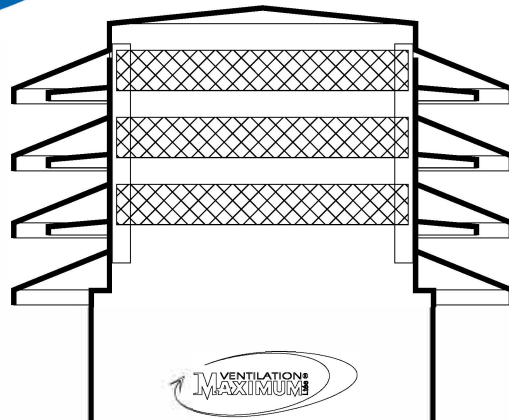

IMPORTANT NOTICE:
Refer to section 9.19.1.2 of the
National Building Code for
required ventilation.

N.B. Secure the ventilator head to
the base flashing with self tapping
screws provided into each of the
perforated holes.

Insulated
Flashing

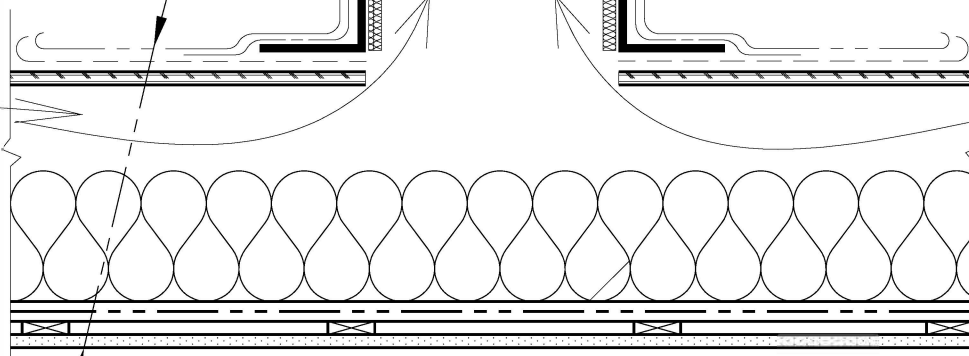

- ROOF MEMBRANES
- ROOF DECK
- AIR SPACE
- INSULATION
- VAPOR BARRIER
- FURRINGS
- GYPSUM

This CROSS SECTION is only an example.
(VENTILATION MAXIMUM Ltd.)

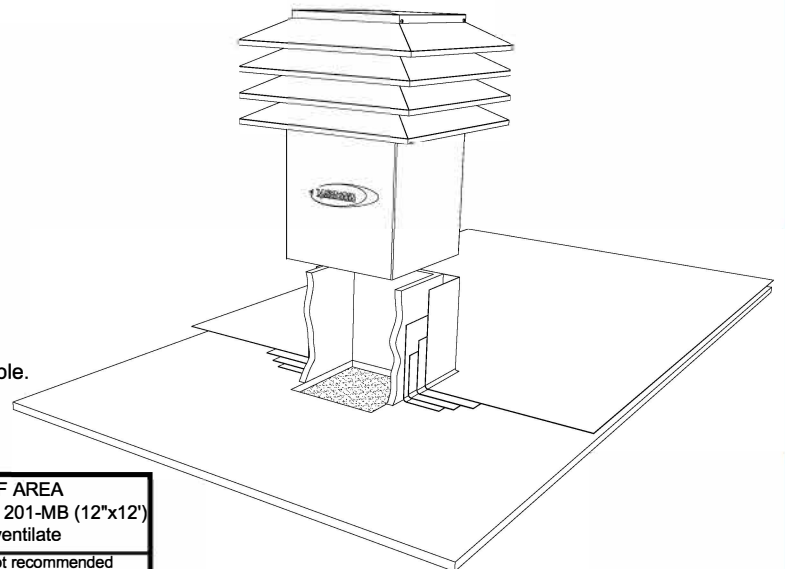

AIR SPACE between the underside of the roof deck and the insulation	ROOF AREA that 1 ventilator 201-MB (12"x12") can ventilate
2.5 to 6 inches	201-MB is not recommended use model 102-MB
7 to 12 inches	151-250 sq. feet
13 to 24 inches	251-350 sq. feet
25 inches and more	351-450 sq. feet