

1 Remove eavestrough.

2a Remove the nails holding the fascia and remove fascia.

3 Remove nails securing the soffits as well as the old soffits and dispose of. Should there be materials under the soffits, it should be removed completely. Verify that there are no blocker boards obstructing the air flow.

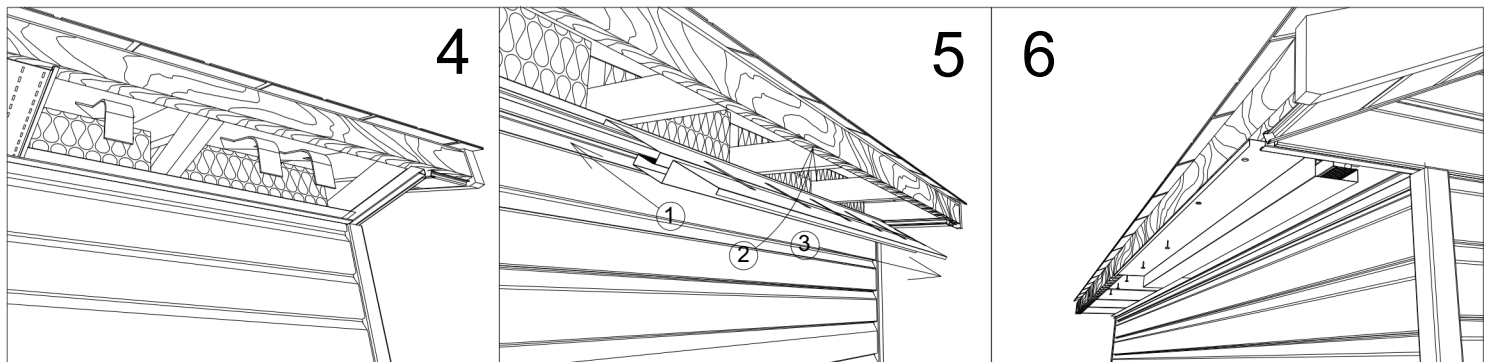

4 Verify that there is sufficient air space between insulation and underside of roof deck and correct as necessary. Verify that the insulation is in good condition and has been properly installed.

5 Start at one extremity of the cornice, take a length of anti-gust soffit and place in existing J-Trim, rotate the soffit towards the fascia and push against track. Follow steps as shown.

6 Fasten the length using aluminium nails onto the fascia.

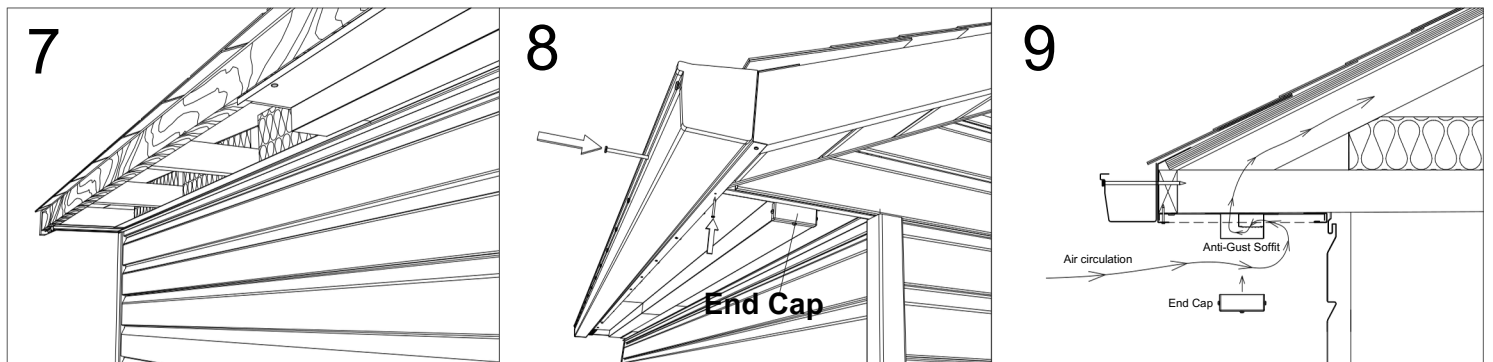

7 Repeat steps 5 and 6 for all the other lengths of soffits. At the last section, if you have to cut, make sure to cut straight and square.

8 Install an End Cap at each end of the installation using metal screws. Re-install the fascia and eavestrough.

9 Shown is the air circulation path of the anti-gust soffit.

**NOTE 1:** Make sure that there are no exhaust vents dumping into the soffits, if so relocate the exhaust onto the roof by installing our CT-Roof Exhaust unit especially made for this application.

**NOTE 2:** By exhausting into the soffits, the exhaust will be drawn right back into the attic space, defeating the purpose of moisture control within the attic as well as creating condensation and rot.